

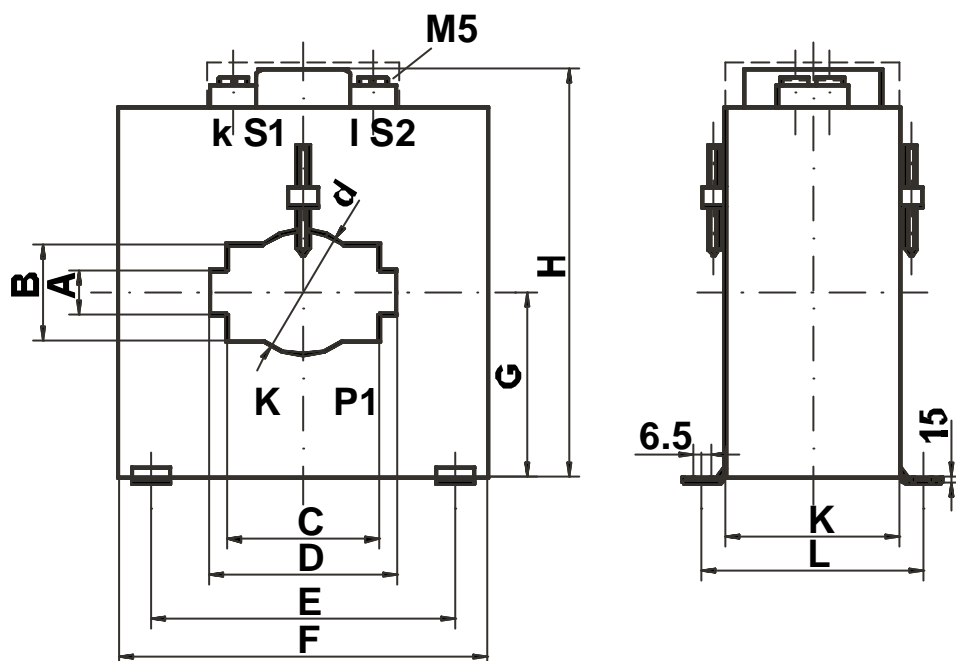

# MASSBLATT - DATA SHEET

## Nr.:JW151 TYP:KAS1 / KAS7



Maße in (mm)	A	B	C	D	d	E	F	G	H	K	L
KAS 1/A/1	-	-	-	-	16	30	50	29	71	30	43
KAS 1/B/1	-	-	-	-	16	30	50	29	71	50	63
KAS 1/C/1	-	-	-	-	16	30	50	29	71	69	82
KAS 1/A/2	-	-	-	-	22	30	50	29	71	30	43
KAS 1/B/2	-	-	-	-	22	30	50	29	71	50	63
KAS 1/C/2	-	-	-	-	22	30	50	29	71	69	82
KAS 2/A/2	-	-	-	-	22	40	60	31	75	30	43
KAS 2/B/2	-	-	-	-	22	40	60	31	75	50	63
KAS 2/C/2	-	-	-	-	22	40	60	31	75	69	82
KAS 2/A/3	11	-	-	31	25	40	60	31	75	30	43
KAS 2/B/3	11	-	-	31	25	40	60	31	75	50	63
KAS 3/31	11	-	-	31	25	40	60	31	75	69	82
KAS 3/3	11	-	-	31	24	50	70	35	84	52	66
KAS 3/4	11	-	-	41	30	50	70	35	84	52	66
KAS 3/33	-	-	-	-	33	50	70	35	84	52	66
KAS 3/41	-	-	-	-	41	50	70	35	84	52	66
KAS 4/4	13	31	31	41	36	65	85	43	102	61	75
KAS 4/5	13	31	41	51	44	65	85	43	102	61	75
KAS 5/6	11	31	51	61	45	78	100	51.5	117	64	78
KAS 5/26	31	37	51	61	52	78	100	51.5	117	64	78
KAS 6/5 (IW928)	11	51	11	51	32	110	135	67.5	152	64	78
KAS 6/5 (IW929)	11	-	-	51	-	110	135	67.5	152	64	78
KAS 6/8	11	31	61	81	52.5	110	135	67.5	152	64	78
KAS 6/26	31	37	51	61	52.5	110	135	67.5	152	64	78
KAS 6/10	11	31	81	101	60.5	110	135	67.5	152	64	78
KAS 6/210	31	51	81	101	60.5	110	135	67.5	152	64	78
KAS 7/12	11	31	101	121	84	110	185	92.5	209	61	75
KAS 7/212	31	51	101	121	84	110	185	92.5	209	61	75